



SPIN LED

☆ SPIN LED

m² 0,015
 ↳ 495x220x140mm

♻️ 1 Pcs
 ↳ 70 pcs



CODICE Code	CABLAGGIO Wiring	POTENZA Power(W)	FLUSSO NOM. Typical Flux(lm)	COLORE LED Beam color(K)	APERTURA FASCIO Beam angle(α)	CORRENTE Current(A)	PESO NETTO Net weight(Kg)	SORGENTE Light source	COLORE Colour
414643.133	LED	1x33,8W	3600	3000	24°	1,00	2,67	Osram	■
414643.134	LED	1x33,8W	3600	4000	24°	1,00	2,67	Osram	■
414643.135	LED	1x33,8W	3600	3000	40°	1,00	2,67	Osram	■
414643.136	LED	1x33,8W	3600	4000	40°	1,00	2,67	Osram	■
414643.233	LED	2x33,8W	7200	3000	24°	1,00	3,14	Osram	■
414643.234	LED	2x33,8W	7200	4000	24°	1,00	3,14	Osram	■
414643.235	LED	2x33,8W	7200	3000	40°	1,00	3,14	Osram	■
414643.236	LED	2x33,8W	7200	4000	40°	1,00	3,14	Osram	■



Spin LED

Corpo, cornice e vano ottico: pressofusione di alluminio.
Verniciatura: polvere di poliestere termoindurente, finitura satinata.
Modulo POWER LED: 33,8W, 3600lm, 3000/4000K.
Alimentazione: 220/240V 50/60Hz elettronica.
Adattatore trifase: tecnologia Nokia, fornito di serie, già montato sul prodotto.

Housing, frame and optical compartment: die-cast aluminium.
Paintwork: thermosetting polyester powder, satin finished.
POWER LED module: 33,8W, 3600lm, 3000/4000K.
Power supply: 220/240V 50/60Hz with electronic ballast.
3 phase Adapter: with Nokia technology, standard supplied, already mounted.

COLORI DISPONIBILI Available colours

- 3 Argento RAL 9006
RAL 9006 Silver

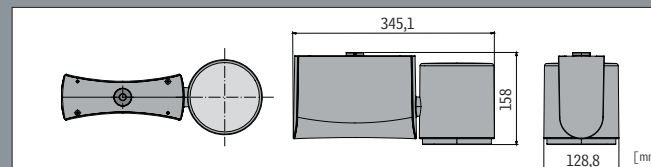

SPIN 1X

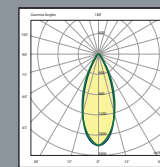

LED 1x33,8W 1,00 A

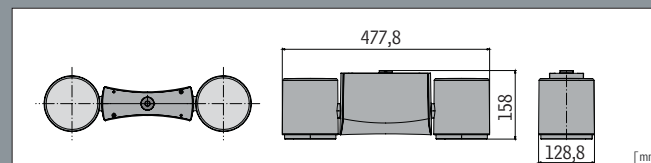

SPIN 2X



Dettaglio adattatore trifase
3 phase adapter detail

PROIETTORI PER INTERNI

Indoor floodlights



SPIN LITE

☆ SPIN LITE

m² 0.015
 495x220x140mm

1 Pcs
 140 pcs



CODICE Code	CABLAGGIO Wiring	POTENZA Power (W)	PORTALAMPADA Lampholder	ESECUZIONE Execution	FLUSSO NOM. Typical Flux (lm)	COLORE LED Beam color (K)	APERTURA FASCIO Beam angle (α)	PESO NETTO Net weight (Kg)	SORGENTE Light source	COLORE Colour
416003.102	NC		E27	CN				1,38		□
416943.175	ALO	75W	E27	CNL				1,68	☛	□
416943.110	ALO	100W	E27	CNL				1,68	☛	□
416643.115	LED	15W			1200	3000	40°	1,68	Osram ☛	□
416643.116	LED	15W			1200	4000	40°	1,68	Osram ☛	□
416643.120	LED	22W			1800	3000	40°	1,68	Osram ☛	□
416643.121	LED	22W			1800	4000	40°	1,68	Osram ☛	□

Corpo, cornice e vano ottico: pressofusione di alluminio.
Verniciatura: polvere di poliestere termoindurente.
Modulo POWER LED: 15/22W, 1200/1800lm, 3000/4000K.
Alimentazione: 220/240V 50/60Hz.
Adattatore trifase: tecnologia Nokia, fornito di serie, già montato sul prodotto.



Housing, frame and optical compartment: die-cast aluminium.
Paintwork: thermosetting polyester powder.
POWER LED module: 15/22W, 1200/1800lm, 3000/4000K.
Power supply: 220/240V 50/60Hz.
3 phase Adapter: with Nokia technology, standard supplied, already mounted.

COLORI DISPONIBILI Available colours

- 3 Argento RAL 9006
RAL 9006 Silver

Simbologia Symbology.....pag. 12
 Accessori Accessories.....pag. 66

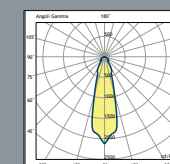
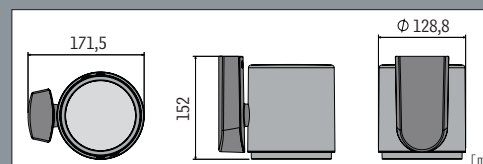

LED 22W α40°



Dettaglio adattatore trifase
3 phase adapter detail



Binari trifase
3 phase tracks

- 1 Bianco
White
- 2 Nero RAL 9005
RAL 9005 Black
- 3 Argento RAL 9006
RAL 9006 Silver



NICE & SPIN Composizione binario

I codici sono disponibili sul listino generale 2016
Codes are available on our 2016 price list

Track composition

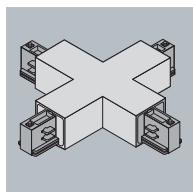

Congiunzione a X
X joint

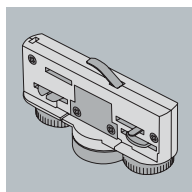

Adattatore
Track adapter

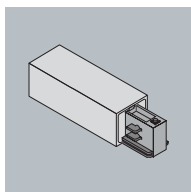

Connettore alimentatore
Live end

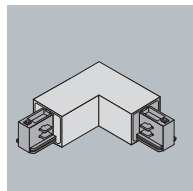

Giunto a L esterno
Outside L joint

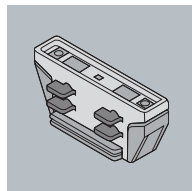

Congiunzione lineare C
Electrical straight C joint

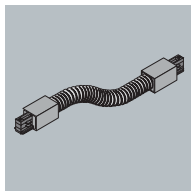

Congiunzione flessibile 30mm
30mm flexible joint

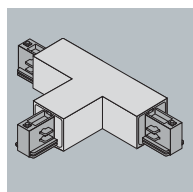

Congiunzione a T
T joint

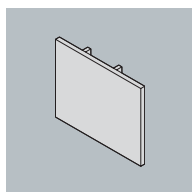

Terminale di chiusura
Dead end

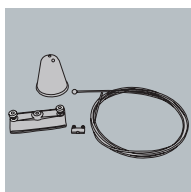

Kit di sospensione per binario
Suspension kit for track





NICE & SPIN Binario - Track

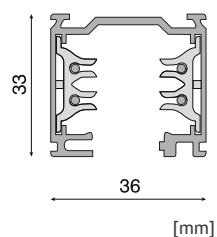

Sistema a binario trifase, a 3 accensioni, per installazione sporgente.

Tensione di rete applicabili 230/250V - 16A e 380/440V.

Three-phase with 3 switching track system for external installation.

Usable voltages 230/250V - 16A and 380/440V.

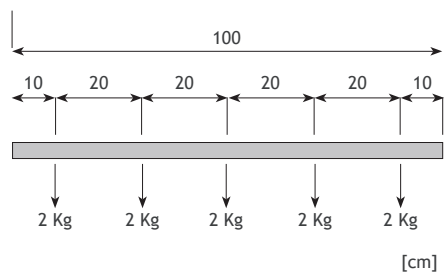

Il binario trifase può sopportare un carico di 2 Kg ogni 20 cm con una distanza massima fra i punti di fissaggio di 100 cm. Nel caso di carichi superiori la distanza di fissaggio si riduce a 50 cm.

The three-phase track can support a load of 2 kg every 20 cm with a maximum distance between the fixing points of 100 cm. In case of heavier loads, the fixing distance is shortened to 50 cm.

SCHEMI ELETTRICI - Wiring diagrams

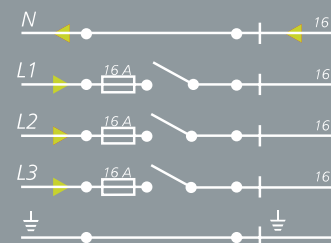

Il collegamento alla rete elettrica trifase 230/400V consente un carico complessivo di 16A, che corrisponde a 11040 Watt ripartibili su tre circuiti (3x3680 Watt).

The connection to a three phase 230/400V electricity mains allows a total load of 16A, corresponding to 11040 Watt, which can be divided among the 3 circuits (3x3680 Watt).



Continuità della messa a terra Continuity of the earthing

Per una corretta installazione di tutti gli accessori, che concorrono alla formazione di un impianto di binari trifase, ha grande importanza la continuità della linea di messa a terra tra ogni elemento.

Il posizionamento dei conduttori di terra, infatti, deve essere consequenziale tra componente e componente.

For a correct installation of all the accessories which make up a three phase track installation, the continuity of the earthing between each element is extremely important. In fact, the positioning of the earth conductors must be consequential between the components.

