

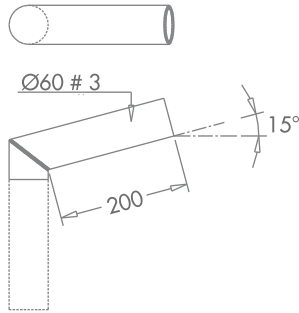

## Attacchi a “pipa” Small brackets connection

pipetta a 1 via  
single small bracket  
(C84/....)



pipetta a 2 vie  
double small bracket  
(C84B/....)

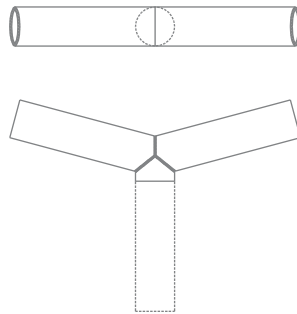

pipetta a 3 vie  
triple small bracket  
(C84T/....)

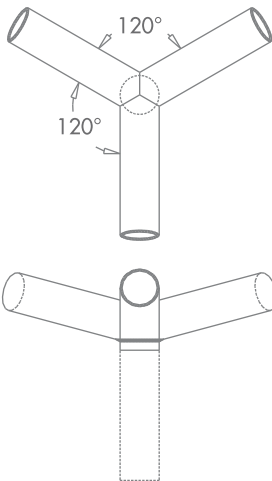

pipetta a 4 vie  
quadruple small bracket  
(C84Q/....)

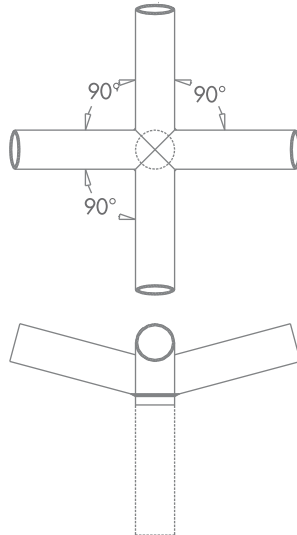

Small brackets connection

### Attacchi a “pipa”

(braccetti a squadra),  
costruiti utilizzando tubi saldati  
longitudinalmente ad induzione  
UNI EN 10219/2,  
in acciaio di qualità  
S235JRH EN 10219/1.

### Tolleranze dimensionali

UNI EN 40/2 - UNI EN 10219/2.

La **zincatura** viene ottenuta  
mediante immersione  
in vasche di zinco fuso.

Lo **spessore** dello strato di zinco  
sarà conforme alle normative  
UNI EN 40 parte 4.

### Straight small brackets,

manufactured employing  
longitudinal induction  
welded pipes  
UNI EN 10219/2,  
steel grade S235JRH EN 10219/1.

### Dimensional Tolerance

UNI EN 40/2 - UNI EN 10219/2.

### The galvanisation

is made by dipping in to bath  
of melted zinc.

### The thickness

of the zinc coating will be  
according to UNI EN 40 .

# attacchi a pipa

Accoppiamento tra palo e braccio.  
Coupling between column and bracket.

